



Drivemoor, Abbeydale, Gloucester GL4

5XP

Freehold

£315,000

**17 Drivemoor, Abbeydale, Gloucester,
Gloucestershire, GL4 5XP**

£315,000

Freehold. Council Tax Band D



3 Bedrooms



1 Bathrooms



3 Receptions

Features

- * NO ONWARD CHAIN
- * 3 BEDROOM
- * DETACHED
- * CONSERVATORY
- * POPULAR LOCATION
- * GARAGE
- * OFF ROAD PARKING
- * EPC D COUNCIL TAX BAND D

Michael Tuck Estate and Letting Agents

2 Mead Road Abbeymead Gloucester Gloucestershire GL4 5GL

01452 612020

estates.abbeymead@michaeltuck.co.uk

www.michaeltuck.co.uk

The Property

**** NO ONWARD CHAIN, THREE BEDROOM
DETACHED HOUSE IN POPULAR LOCATION OF
ABBEYDALE **** Now available this lovely design
three bedroom detached house on the popular
road of Drivemoor Abbeydale. This property is
conveniently located to a wide range of local
amenities such as; doctor surgeries,
primary/secondary school, supermarkets and bus
routes. In brief the property comprises of;
spacious lounge/diner, cloakroom, kitchen, three
bedrooms and a generous sized conservatory.
Further benefits include, Gas Central Heating,
UPVC double glazed windows, ample off road
parking, enclosed rear garden and a garage. This
property has so much to offer and has incredible
potential! Property for sale through Michael Tuck
Estate Agents. Approximate rental value of
£1,300pcm , please contact Michael Tuck Lettings
in Abbeymead for more details. To arrange a
viewing call us today on 01452 612020

Entrance Hall

Cloakroom

Kitchen 12' 0" x 10' 6" (3.65m x 3.21m)

Utility room 7' 7" x 4' 11" (2.30m x 1.51m)

Lounge 14' 10" x 11' 9" (4.52m x 3.59m)

Dining Room 11' 8" x 10' 2" (3.56m x 3.11m)

Conservatory 17' 10" x 8' 1" (5.44m x 2.46m)

Bedroom 1 11' 11" x 11' 9" (3.64m x 3.59m)

Bedroom 2 11' 9" x 10' 7" (3.59m x 3.22m)

Bedroom 3 8' 10" x 6' 5" (2.69m x 1.96m)

Shower Room 6' 10" x 5' 7" (2.09m x 1.69m)

Additional Information From Vendor

Water - Mains

Gas - Mains

Electric - Mains

Broadband - Unknown







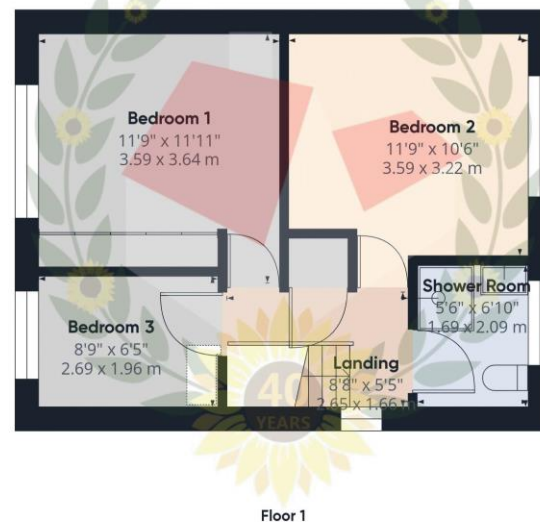
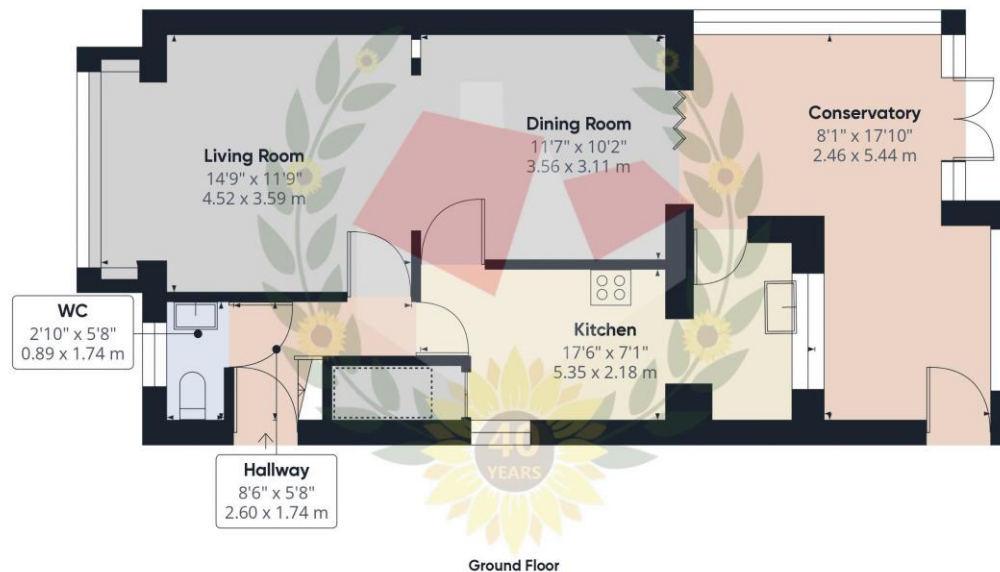

Approximate total area⁽¹⁾

1059.36 ft²

98.42 m²

Reduced headroom

13.14 ft²

1.22 m²

Excluding balconies and terraces

Reduced headroom
(below 1.5m/4.92ft)

While every attempt has been made to ensure accuracy, all measurements are approximate, not to scale. This floor plan is for illustrative purposes only.

GIRAFFE360

FOR ILLUSTRATIVE PURPOSES ONLY – NOT TO SCALE

The position and size of doors, windows, appliances, and other features are approximate only.

Unauthorised reproduction prohibited

Important notice: Michael Tuck, its clients and any joints give notice that 1: They are not authorised to make or give any representations or warranties in relation to the property either here or elsewhere, either on their own behalf of their client or otherwise. They assume no responsibility for any statement that may be made in these particulars. These particulars do not form part of any offer or contract and must not be relied upon as statements or representation of fact. 2: Any areas, measurements or distances are approximate. The text, photographs and plans are for guidance only and are not necessarily comprehensive. It should not be assumed that the property has all necessary planning, building regulation or other consents and Michael Tuck have not tested any services, equipment or facilities. Purchasers must satisfy themselves by inspection or otherwise.

